

TECHNICAL DATA SHEET

**Two-way solenoid valve ELEPHANT-DHD31-NO
coupling, pilot-operated DN10-DN50 (3/8" - 2"),
normally open type, with coil 220V/24V**



GENERAL PRODUCT INFORMATION

Product name: Two-way solenoid valve ELEPHANT-DHD31-NO socket solenoid valve DN10-DN50 (3/8" - 2"), normally open type, with 220V/24V coil.

Purpose: A normally open solenoid valve is a valve which is open to the flow of medium through it when no voltage is applied to its induction coil. When voltage is applied to the coil, this type of solenoid valve closes and remains closed for as long as voltage is applied to the coil.

In domestic applications, such solenoid valves are used in automobiles, special vehicles, water supply systems and auto irrigation and heating systems, as well as in industry to regulate and control the transportation of liquids and gases.

Attention! Pilot-operated valves may be installed **ONLY** on a horizontal pipeline section.



BASIC TECHNICAL DATA AND CHARACTERISTICS

Nominal diameter DN, mm (inch)	10 – 50 (3/8"-2")
Working pressure PN, bar	0,5...13
Working medium temperature t, °C	-10 to +80: NBR -10 to +150: VITON -10 to +120: EPDM
Working medium	Hot and cold water, liquid media, steam, air, gaseous media, light oils (viscosity $\leq 20\text{cSt}$)
Operating principle	pilot
Device type	Normally open
Pipeline connection	threaded
Thread type	G
Coil supply	AC220V or DC24V
Body material	Brass/steel 316
Sealing	NBR/VITON/EPDM
Protection class	IP65
Coil insulation class	F
Coil type	<ul style="list-style-type: none"> • Normal • Low power (*option)
Coil construction	With DIN connectors
Valve life	1 million cycles
Models by	<ul style="list-style-type: none"> • 0545 (25VA(AC), 13W(DC), IP65, encapsulation complete) • 0543 (22VA(AC), 13W(DC), IP65, encapsulation complete) • S21B (24VA(AC), 17W(DC), IP65, full encapsulation) • S91B (22VA(AC), 17W(DC), IP65, full encapsulation) • S92B (22VA(AC), 17W(DC), IP65, full encapsulation)



BASIC VALVE DIMENSIONS

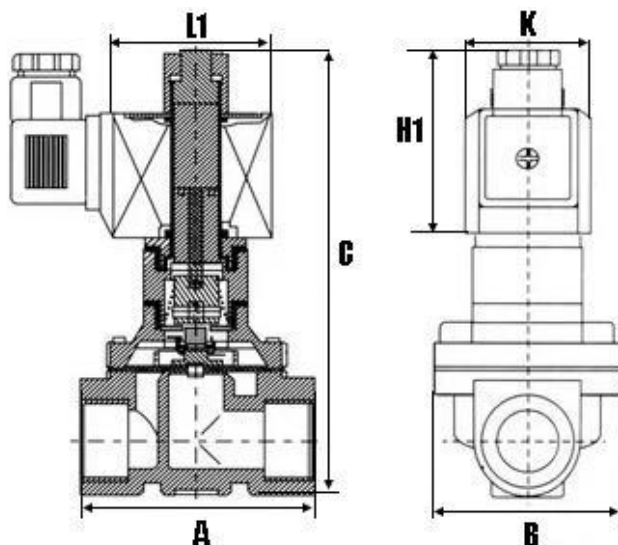

DN	mm	10	15	20	25	32	40	50
Ø aisle	inch	3/8"	1/2"	3/4"	1"	1 1/4"	1 1/2"	2"
Ø holes	mm	13	13	20	25	32	40	50
A		66	66	75	96	131	131	165
B		48	48	58	70	96	96	120
C		124	124	130	143	158	158	179
H1		42.3	42.3	42.3	42.3	42.3	42.3	42.3
L1		39	39	39	39	39	39	39
K		30	30	30	30	30	30	30
Ø coil stem		15	15	15	15	15	15	15
Weight	Brass	kg	1.22	1.20	1.35	1.60	2.95	4.60
	Steel 316		1.22	1.20	1.35	1.50	2.85	4.40



BASIC VALVE PARAMETERS

DN	Ø aisle	Ø sections	Throughput	Working pressure (bar)			Coil power			
				Minimum pressure	Maximum pressure		Normal coil		Low power coil	
							VA	W	VA	W
mm	inch	mm	m3/hour	bar	AC	DC	AC 220V	DC 24V	AC 220V	DC 24V
10	3/8"	13	4.5	0.5	13	13	20	13	4	4
15	1/2"	13	4.5	0.5	13	13	22	13	4	4
20	3/4"	20	7.6	0.5	13	13	22	13	4	4
25	1"	25	12	0.5	13	13	22	13	4	4
32	1 1/4"	32	22	0.5	13	13	22	13	4	4
40	1 1/2"	40	30	0.5	13	13	22	13	4	4
50	2"	50	46	0.5	13	13	22	13	4	4



WARRANTY PERIOD

Warranty period - 12 months from the date of commissioning, but not more than 18 months from the date of sale.

The warranty does not apply:

- parts and materials of the product subject to wear and tear
- for cases of damage caused by:
 - violations of the product storage, installation, testing, operation and maintenance specifications;
 - improper transportation and handling operations;
 - the presence of traces of exposure to substances aggressive to the product materials;
 - presence of damage caused by fire, elements, force majeure circumstances;
 - damage caused by incorrect actions of the consumer;
 - traces of tampering with the design of the product.

SALES MARK

No	Product Name	Packs

Date of Sale: _____

L.S.

