

TECHNICAL DATA SHEET

**Two-way solenoid valve ELEPHANT-DHDF21
submersible fountain valve, pilot operated normally closed
or normally open type, DN10-DN50
with coil 220V or 24V**



GENERAL PRODUCT INFORMATION

Product name: Two-way solenoid valve ELEPHANT-DHDF21 submersible fountain valve, pilot-operated normally closed or normally open type, DN10-DN50 with 220V or 24V coil.

Purpose: Solenoid solenoid fountain valve is designed specifically for controlling water jets in dynamic fountains. Protection class IP 68 allows the valve to be installed directly inside the water structure without the need to take it to a dry room.

Attention! Pilot-acting valves may be installed **ONLY** on a horizontal pipeline section.



BASIC TECHNICAL DATA AND CHARACTERISTICS

Nominal diameter DN, mm	10 – 50 (3/8" – 2")
Working pressure PN, bar	0,3...16
Working medium temperature t, °C	-5 to +80: NBR -10 to +150: VITON -10 to +120: EPDM
Working medium	Hot and cold water, air, gaseous media, liquid media, light oils
Operating principle	pilot
Device type	normally closed or normally open type
Pipeline connection	Threaded
Thread type	G
Coil supply	AC220V or DC24V
Housing material	steel 304/brass
Sealing	NBR/VITON/EPDM
Protection degree	IP68
Coil insulation degree	F
Coil	<ul style="list-style-type: none"> • Normal • Low power (*option)



DHDF21 valve dimensions (normally closed type)

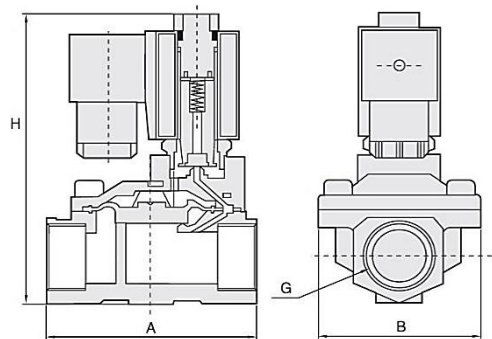

DHDF21 valve dimensions (normally open type)

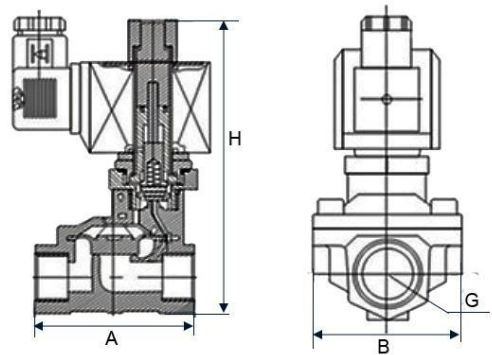

DN	G	Ø holes	A	B	C		Weight	
					H3	HO	H3	HO
					mm		kg	
10	3/8"	13	66	48	107	124	0.92	1.42
15	1/2"	13	66	48	107	124	0.89	1.42
20	3/4"	20	75	58	112	130	1.05	1.52
25	1"	25	96	70	131	143	1.13	1.8
32	1 1/4"	32	131	96	146	158	2.65	3.15
40	1 1/2"	40	131	96	146	158	2.55	3.05
50	2"	50	165	120	167	179	4.3	4.8



BASIC VALVE PARAMETERS

Model	DN	Throughput	Working pressure (bar)			Coil power			
			Minimum pressure	Maximum pressure		Normal coil		Low power coil	
				AC	DC	VA	W	VA	W
		m3/hour				AC 220V	DC 24V	AC 220V	DC 24V
DHDF21-10	10	3.1	0.3	16	16	22	13	3	3
DHDF21-15	15	4.8	0.3	16	16	22	13	3	3
DHDF21-20	20	7.6	0.3	16	16	22	13	3	3
DHDF21-25	25	12	0.3	16	16	22	13	3	3
DHDF21-32	32	24	0.3	16	16	22	13	3	3
DHDF21-40	40	30	0.3	16	16	22	13	3	3
DHDF21-50	50	48	0.3	16	16	22	13	3	3



WARRANTY PERIOD

Warranty period - 12 months from the date of commissioning, but not more than 18 months from the date of sale.

The warranty does not apply:

- parts and materials of the product subject to wear and tear
- for cases of damage caused by:
 - violations of the product storage, installation, testing, operation and maintenance specifications;
 - improper transportation and handling operations;
 - the presence of traces of exposure to substances aggressive to the product materials;
 - presence of damage caused by fire, elements, force majeure circumstances;
 - damage caused by incorrect actions of the consumer;
 - traces of tampering with the design of the product.

SALES MARK

No	Product Name	Packs

Date of Sale: _____

L.S.

