

TECHNICAL DATA SHEET

**Two-way solenoid valve
ELEPHANT-DW11 DN6-DN50 (1/8" - 2")
direct acting normally closed type,
with coil 220V/24V**



GENERAL PRODUCT INFORMATION

Product name: Two-way solenoid valve ELEPHANT-DW11 DN6-DN50 (1/8" - 2") of direct action normally closed type, with coil 220V/24V.

Purpose: Solenoid valve is a special device designed for convenient control of the working medium. This process is carried out in a pressurized pipeline.

In a normally closed solenoid valve, the closed position is maintained if no control voltage is applied to its induction coil. When voltage is applied to the coil, the normally closed valve opens and allows the process medium to flow through. When the control voltage is switched off, the valve closes automatically and blocks the flow of medium in the pipeline.



BASIC TECHNICAL DATA AND CHARACTERISTICS

Nominal diameter DN, mm (inch)	6 – 50 (1/8”-2”)
Working pressure PN, bar	0...10
Working medium temperature t, °C	-5 to +80: NBR -10 to +120: VITON -10 to +120: EPDM
Working medium	Water, liquid media, air, gaseous media, light oils (viscosity ≤ 20 cSt)
Operating principle	direct
Device type	Normally closed
Pipeline connection	Threaded/flanged
Thread type	G
Coil supply	AC220V or DC24V
Housing material	Brass/steel 304
Sealing	NBR/VITON/EPDM
Protection class	IP65
Coil insulation class	F
Coil type	<ul style="list-style-type: none"> • Normal • Low power (*option)
Coil construction	With lead wires
Suitable coil models	<ul style="list-style-type: none"> • Y32B (40VA(AC), 18W(DC), IP65, full encapsulation) • Y42B (50VA(AC), 20W(DC), IP65, full encapsulation)



VALVE DIMENSIONS (DW11-025-06)

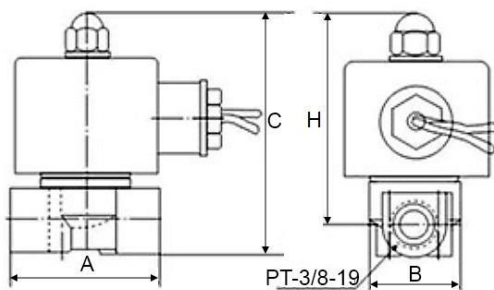

VALVE DIMENSIONS (DW11-040-10)

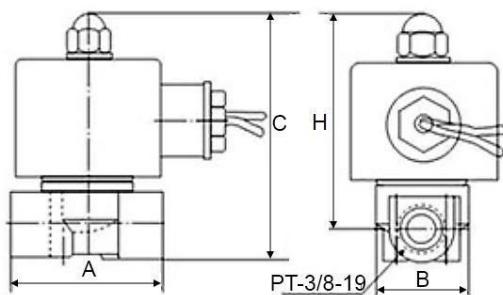

VALVE DIMENSIONS (DN15-DN25)

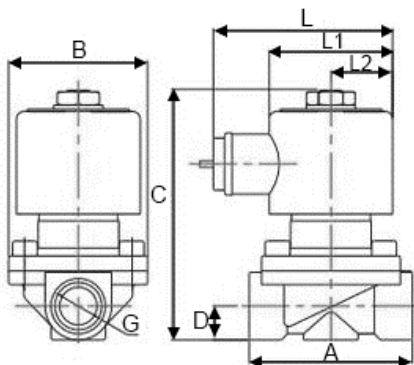

VALVE DIMENSIONS (DN32-DN50)

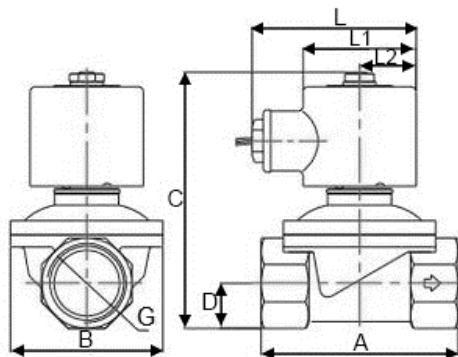

DN	Ø aisle	Ø holes	A	B	C	D	G	L	L1	L2	H	Weight (kg)	
	inch		mm									brass	Steel 304
6	1/8"	2.5	40.5	40.5	75	-	1/8"	-	-	-	66	0.33	0.3
8	1/4"	2.5	40.5	40.5	75	-	1/4"	-	-	-	-	0.32	0.29
10	3/8"	4	52.5	52.5	85.5	16.5	3/8"	-	-	-	74	0.65	0.6
10	3/8"	16	60	45	101	16.5	3/8"	-	-	-	74	0.7	0.62
15	1/2"	16	60	45	101	13.5	1/2"	72.5	50	25	-	0.7	0.62
20	3/4"	20	67	50	107	16.5	3/4"	72.5	50	25	-	0.74	0.62
25	1"	25	82	66	115	20	1"	72.5	50	25	-	1.1	1
32	1 1/4"	32	102	82	147	24	1 1/4"	100	69	34.5	-	2	1.8
40	1 1/2"	40	110	85	153	28	1 1/2"	100	69	34.5	-	2.2	2
50	2"	50	134	108	166	36	2"	100	69	34.5	-	3.1	2.8



Main valve parameters

Model	DN	Ø aisle		Ø holes	Throughput	Working pressure (MPa)				Coil power				Coil model
										Normal coil		Low power coil		
		Minimum pressure		MAX pressure		AC	DC	AC	DC					
DW11-025-06	6	1/8"	2.5		m3/hour	0	0	1.0	0.8	40	18	4	4	Y32B
DW11-025-08	8	1/4"	2.5		0.23	0	0	1.0	0.8	40	18	4	4	
DW11-040-10	10	3/8"	4		0.6	0	0	1.0	0.8	40	18	4	4	
DW11-160-10	10	3/8"	16		3.5	0	0	1.0	0.8	40	18	4	4	
DW11-160-15	15	1/2"	16		3.5	0	0	1.0	0.8	40	18	4	4	
DW11-200-20	20	3/4"	20		7.6	0	0	1.0	0.8	40	18	4	4	
DW11-250-25	25	1"	25		12	0	0	1.0	0.8	40	18	8	7	Y42B
DW11-350-35	32	1 1/4"	35		24	0	0	1.0	0.6	50	20	8	7	
DW11-400-40	40	1 1/2"	40		29	0	0	1.0	0.6	50	20	8	7	
DW11-500-50	50	2"	50		48	0	0	1.0	0.6	50	20	8	7	



WARRANTY PERIOD

Warranty period - 12 months from the date of commissioning, but not more than 18 months from the date of sale.

The warranty does not apply:

- parts and materials of the product subject to wear and tear
- for cases of damage caused by:
 - violations of the product storage, installation, testing, operation and maintenance specifications;
 - improper transportation and handling operations;
 - the presence of traces of exposure to substances aggressive to the product materials;
 - presence of damage caused by fire, elements, force majeure circumstances;
 - damage caused by incorrect actions of the consumer;
 - traces of tampering with the design of the product.

SALES MARK

No	Product Name	Packs

Date of Sale: _____

L.S.

